

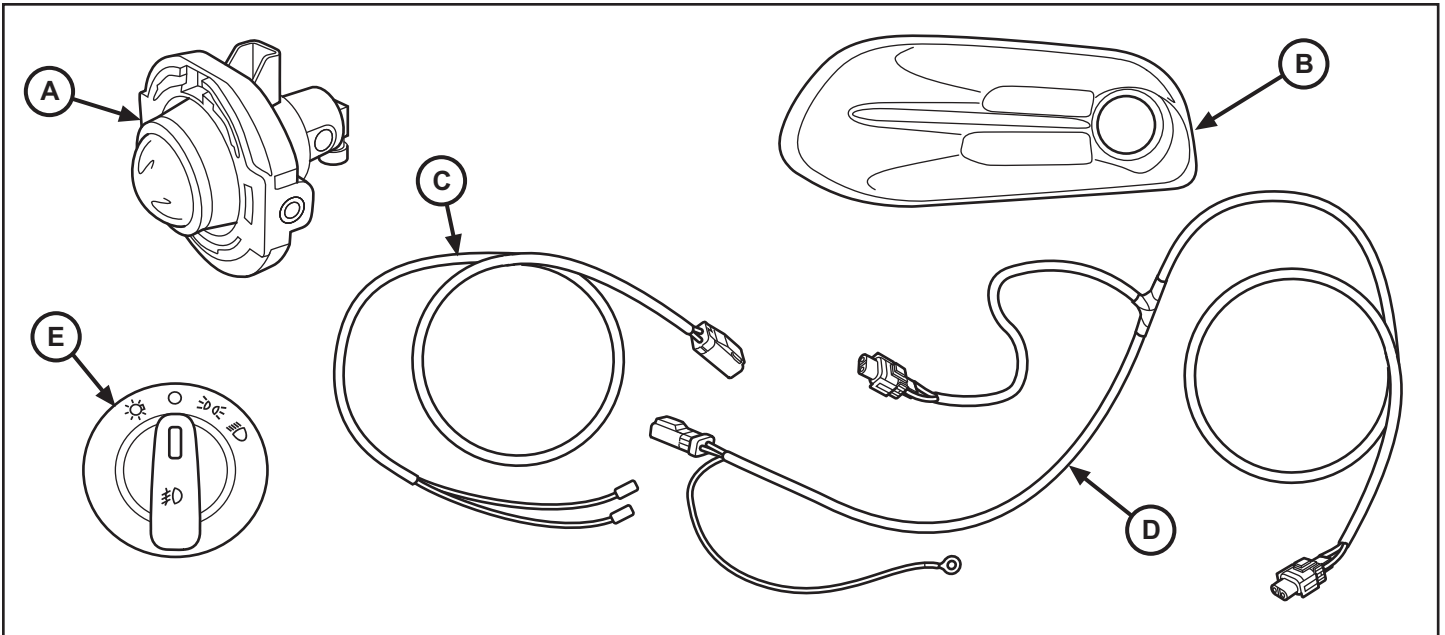

Fog Lights

DODGE DART



CALL OUT	DESCRIPTION	QUANTITY
A	Fog Lamp	2
B	Finisher Bezel	2
C	BCM Harness	1
D	Fog Lamp Harness	1
E	Lamp Switch	1

TOOLS REQUIRED			
Socket Wrench	10mm Socket	8mm Socket	7mm Socket
Trim Stick		Pry Tool	

FOG LIGHTS

1. Mounting locations shown.

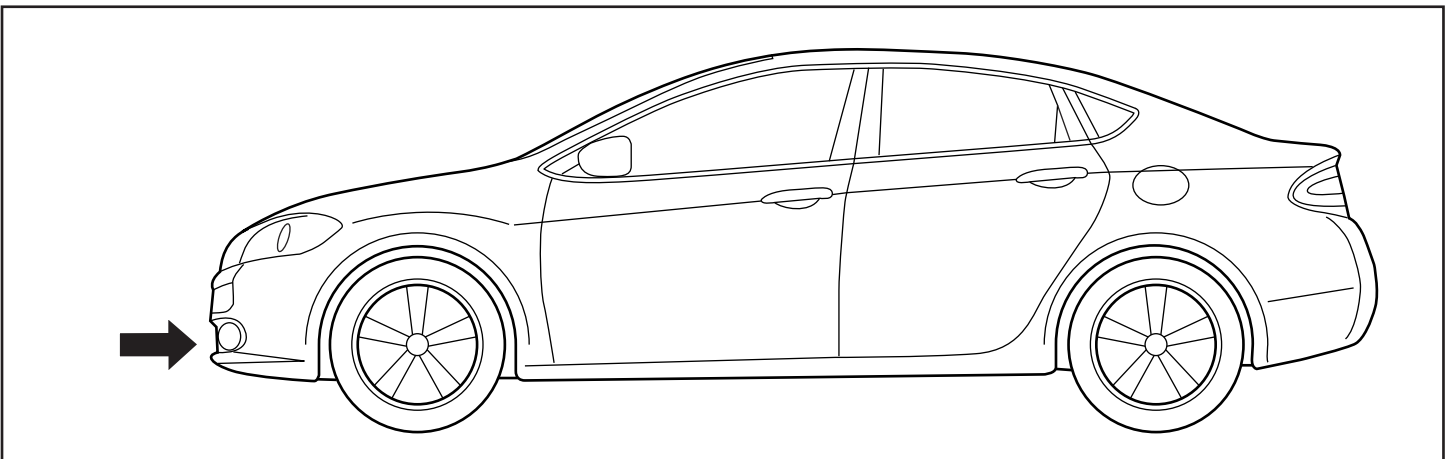

2. Loosen one (1) 10mm bolt and disconnect negative battery cable

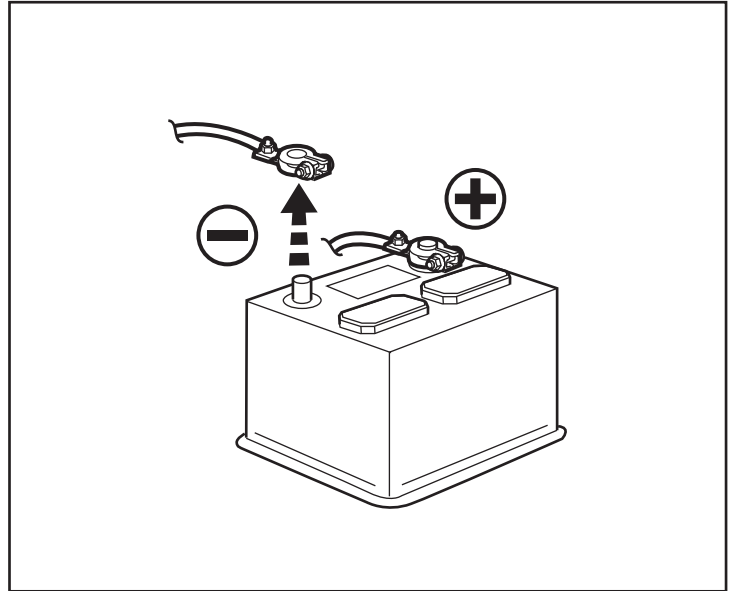

3. Use a trim stick to remove the trim panel from the end of the dash on the driver side.

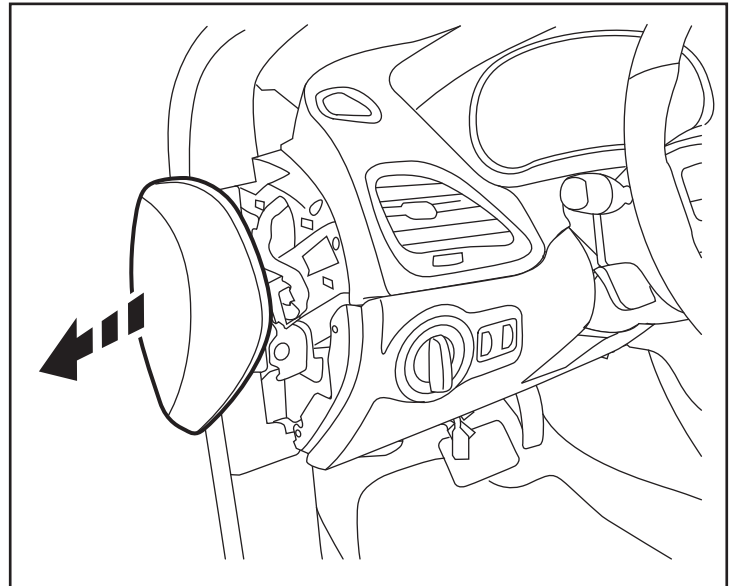

4. Remove three (3) 7mm bolts from lower steering trim panel.

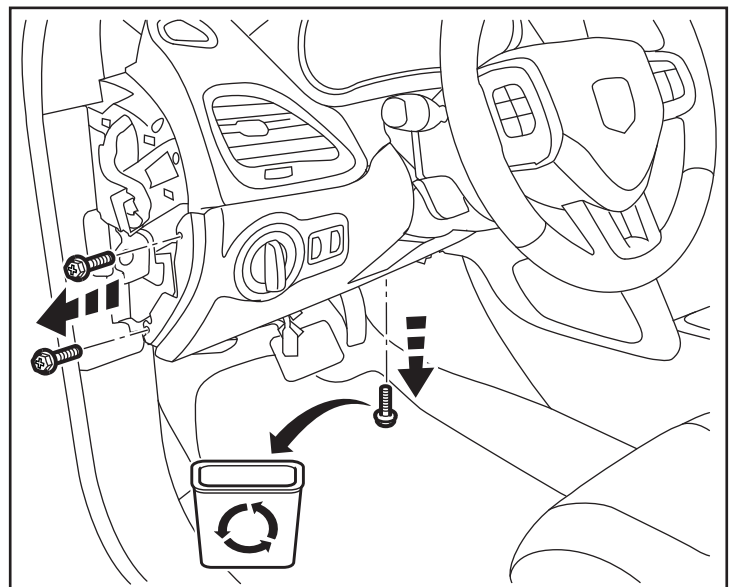

5. Carefully pull panel down. Disconnect four (4) plugs from the back of the panel. Press in on the retainer tab to remove the hood release latch assembly. Completely remove the panel.

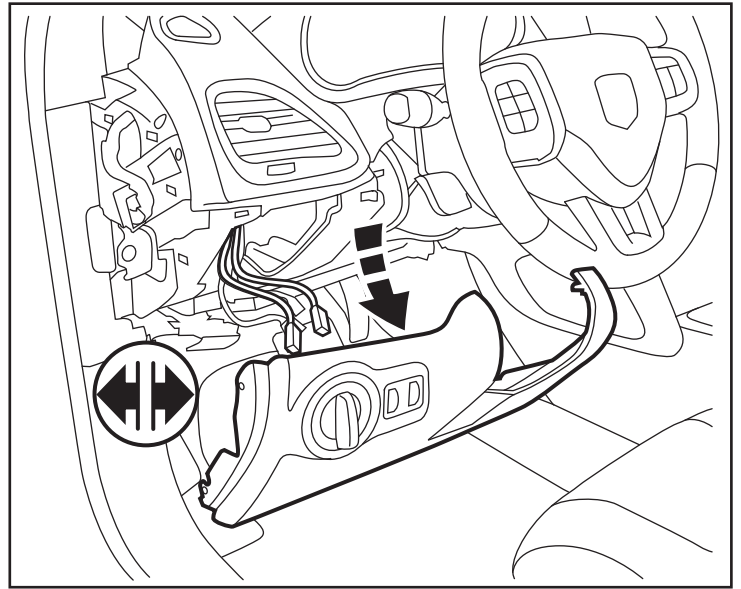

6. Use a pry tool to carefully remove the cover panel under the dash. Disconnect one (1) plug.

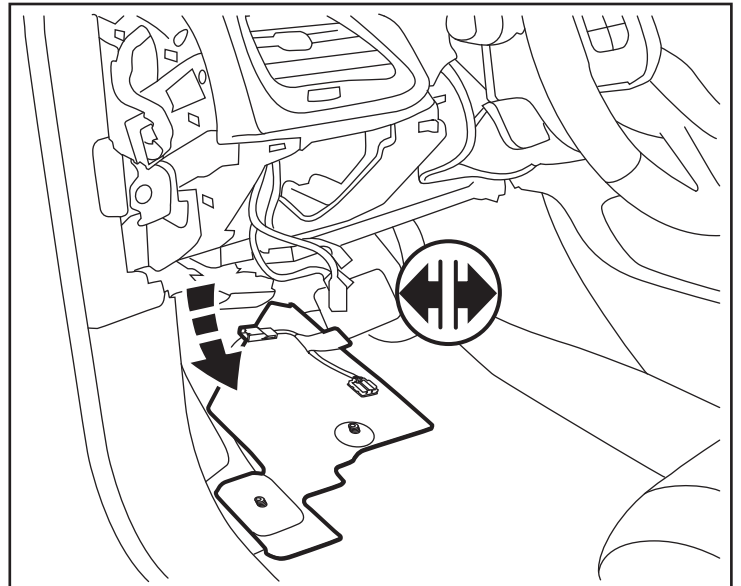

7. Use a trim stick to pry off the door sill trim panel.

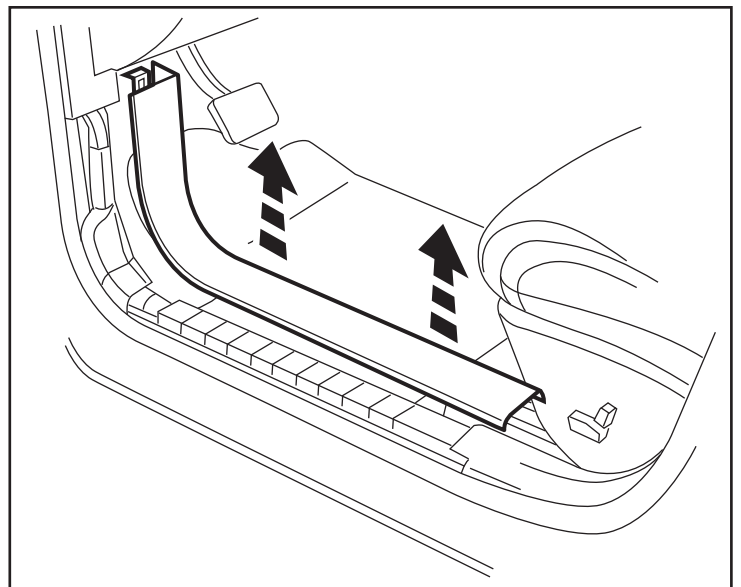

8. Remove two (2) 7mm hex bolts and lower the diagnostic port panel.

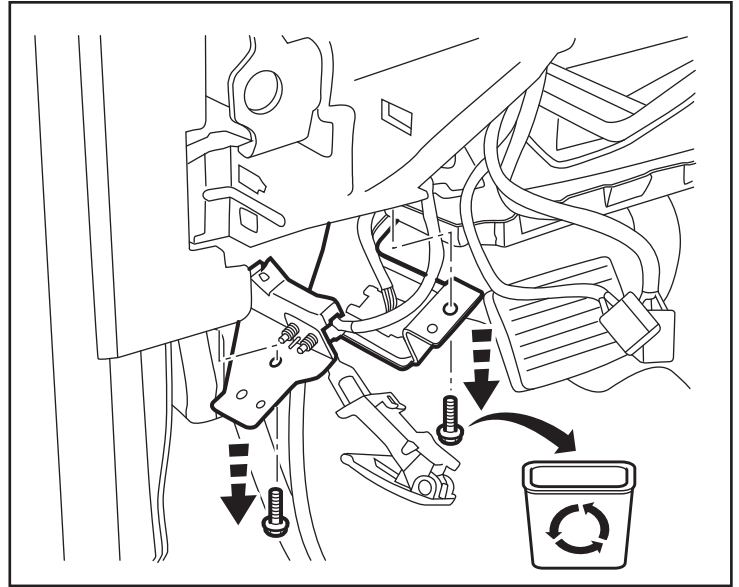

9. Looking up under the dash, locate the C3, 20 way connector at the BCM.

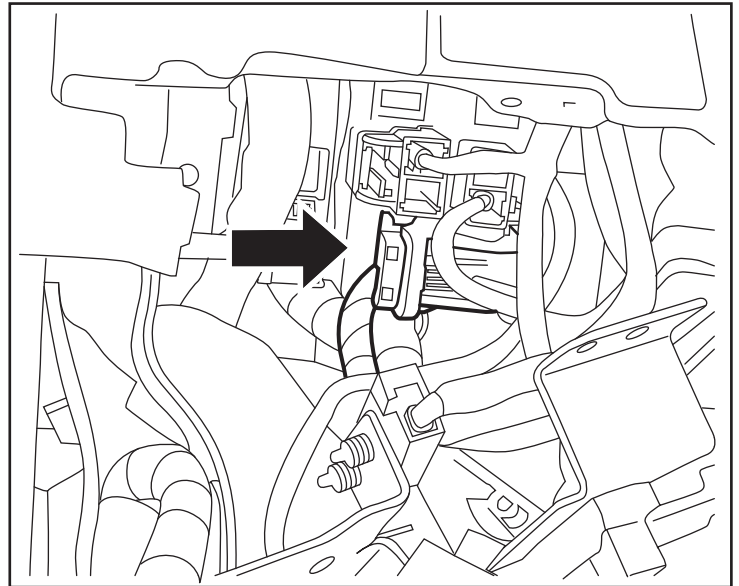

10. Press in on the locking tab and flip the blue retaining lever open to release the C3, 20 way connector.

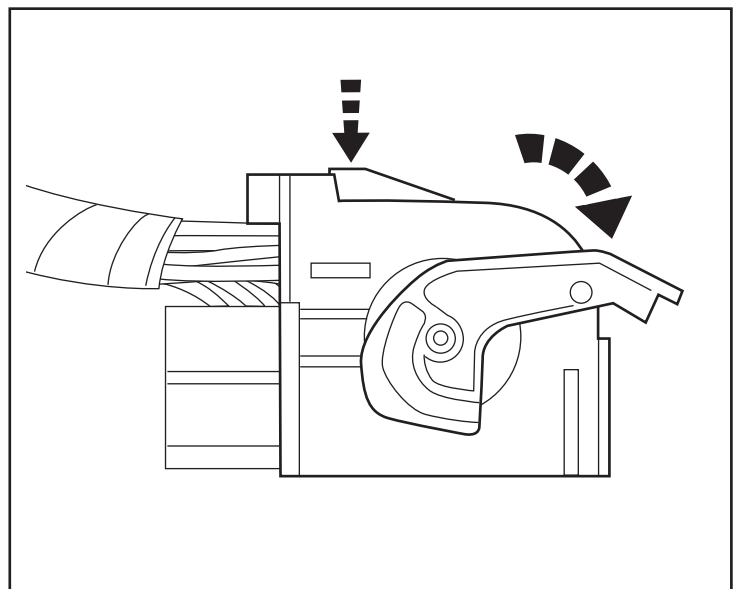

11. Carefully pull the C3, 20 way connector down into the footwell.

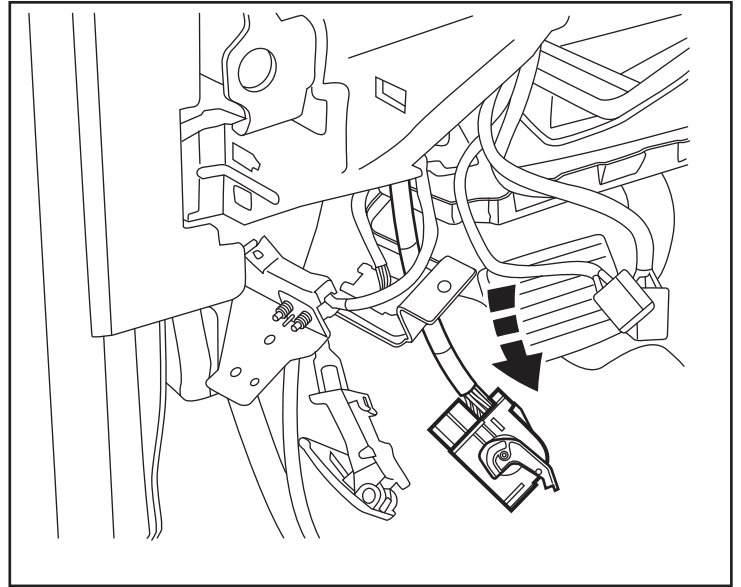

12. Press in on the release tabs at the back of the C3, 20 way connector and slide the plug out from the outer casing.

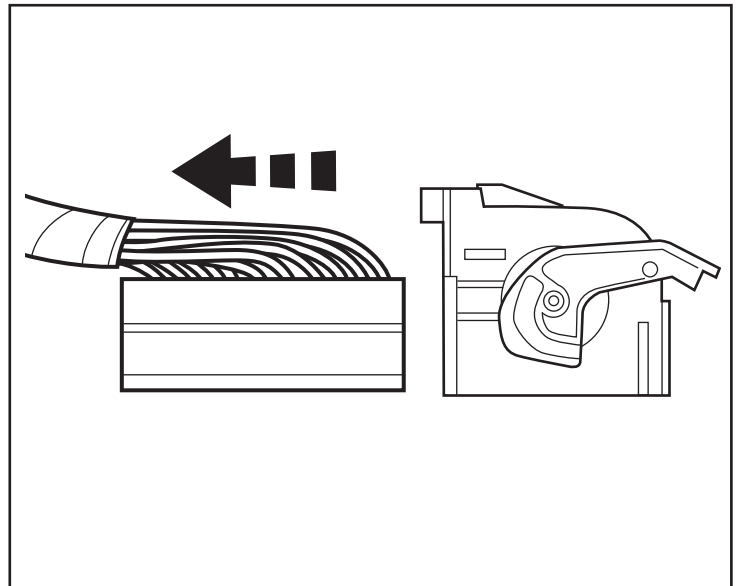

13. Locate the grommet in the firewall behind the brake pedal. Carefully feed a fishing wire through to the engine compartment.

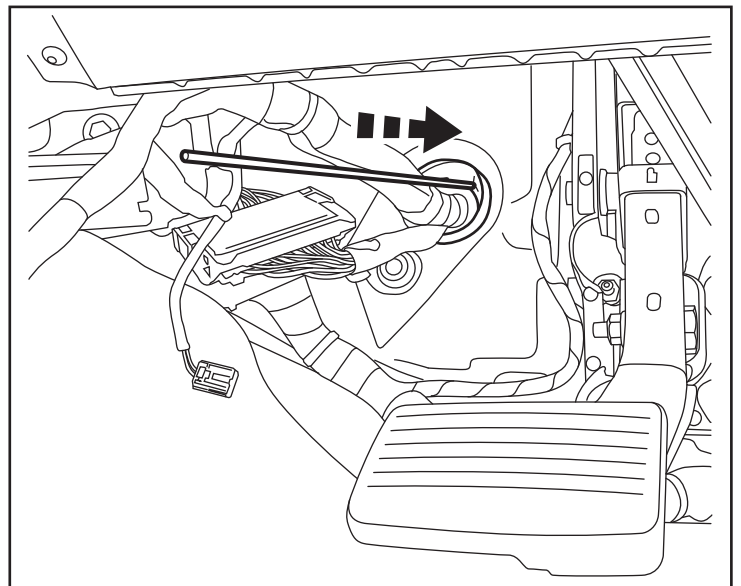

14. Front inside the engine compartment, tape the two wire ends from the BCM harness to the fishing wire and carefully pull the harness through to the inside.

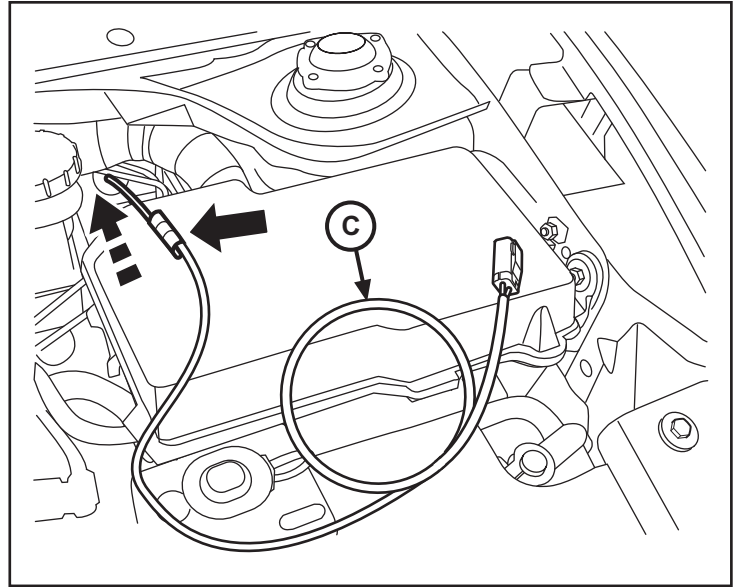

15. Remove the harness from the fishing wire. Carefully insert the two ends from the BCM harness into the wire side of the C3, 20 way connector.

Insert the white/yellow wire into Pin 5 and the white/blue wire into Pin 3 as shown.

NOTE: The cavities in the connector may be populated. If so, the existing wires must be removed and taped back so the supplied wire harness can be installed.

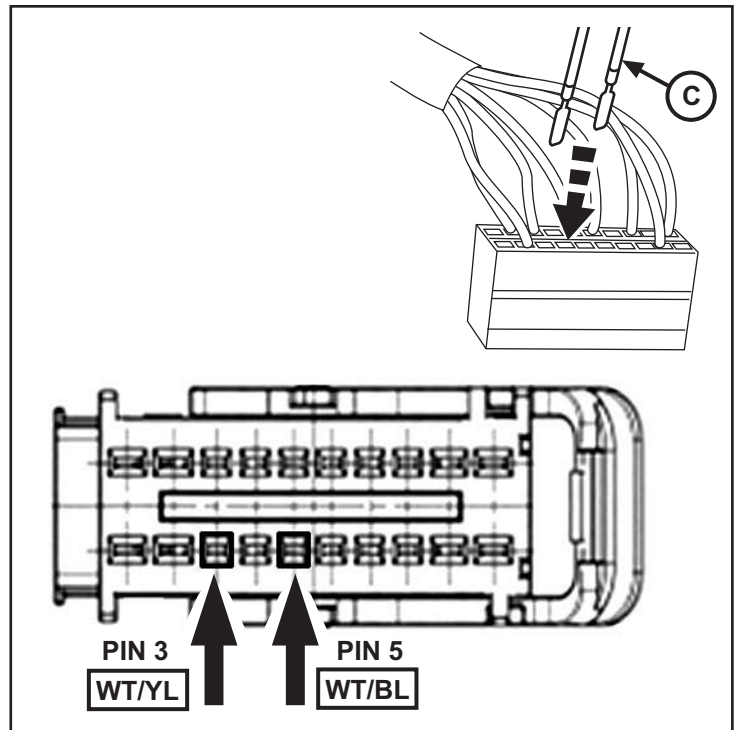

16. Reinstall the plug into the outer casing. Be sure the retaining clips snap into place.

17. Reinstall the C3, 20 way connector into the BCM. Lock the connector in place with the blue retaining handle (see Fig 9).

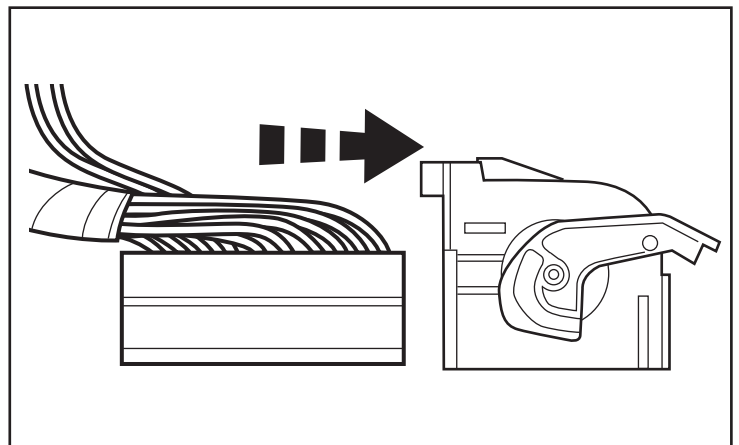

18. Secure the new BCM harness along the existing wire harness with cable ties.

NOTE: Cable ties should be spaced no farther than 150mm apart on the inside of the vehicle.

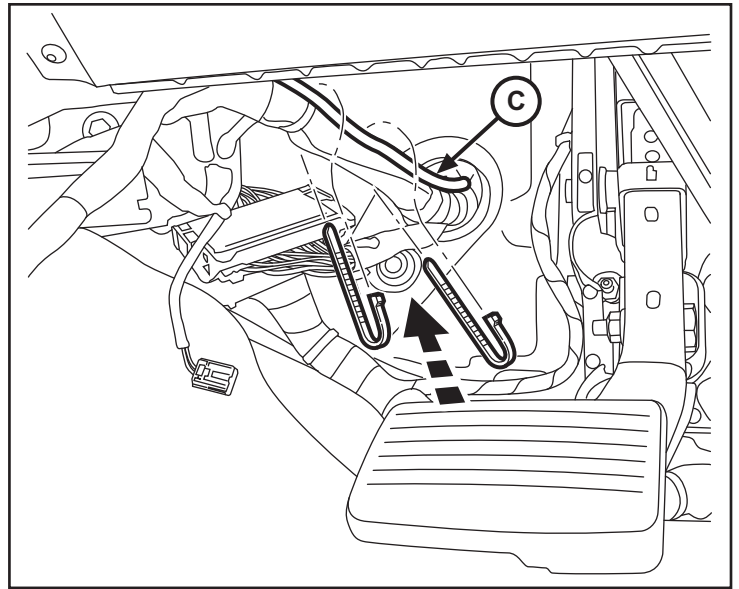

19. From inside the engine compartment, remove one (1) 10mm bolt and two (2) 10mm nuts at the fuse box. Carefully lift the fuse box up out of the way.

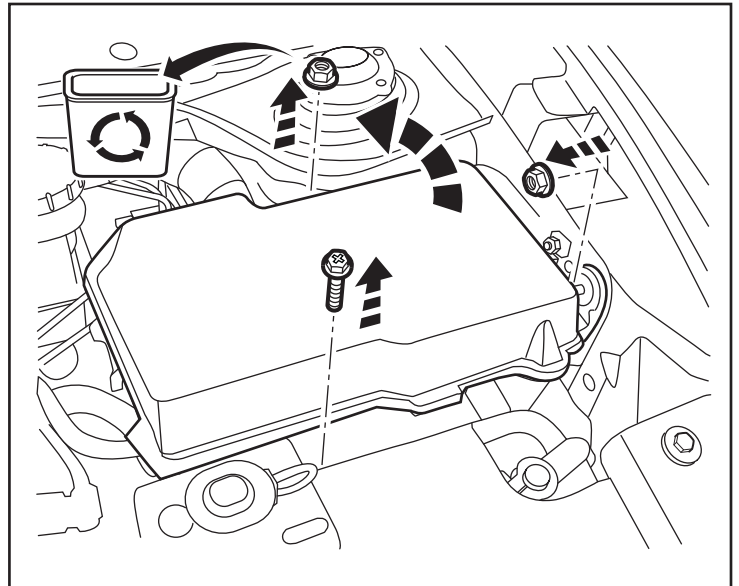

20. Route the new harness along the existing harness under the fuse box and up towards the battery. Secure with cable ties.

NOTE: Cable ties should be spaced no farther than 100mm apart on the outside of the vehicle.

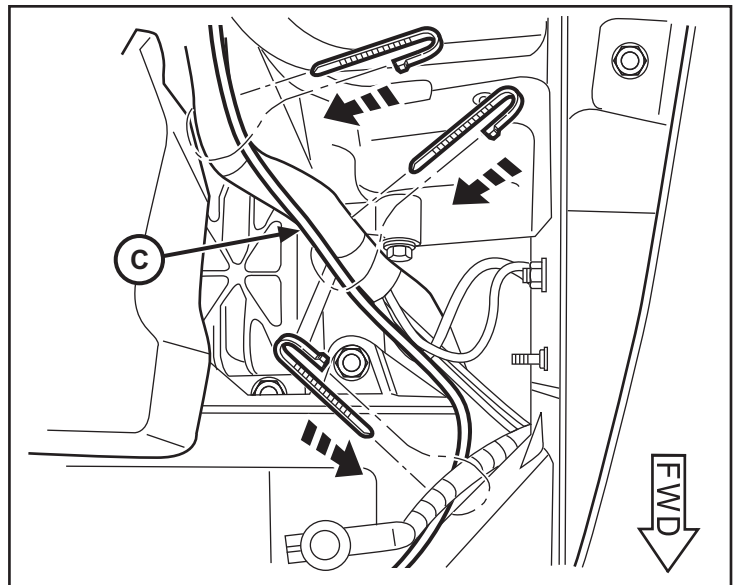

21. Route the end of the BCM harness around the battery and up towards the washer fluid filler cap. Connect the BCM harness and the Fog lamp harness plugs.

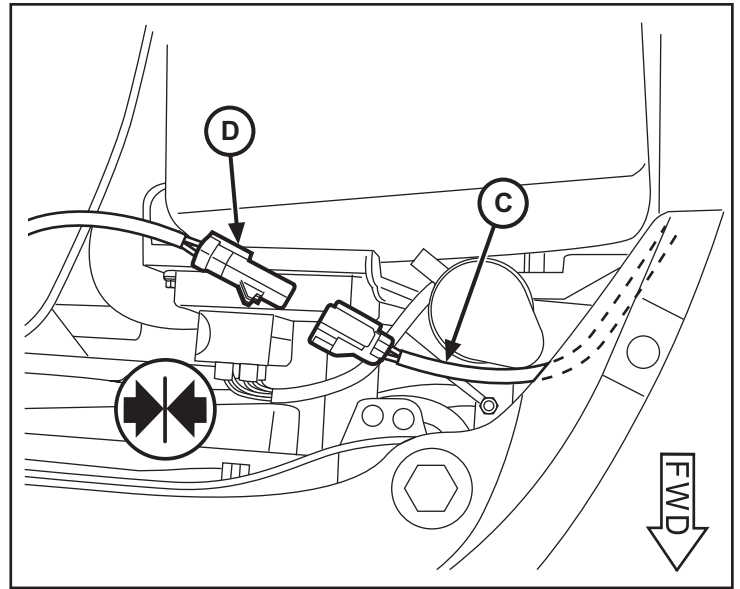

22. Carefully feed the Fog lamp harness down through the open area next to the radiator hose.

NOTE: Harness will rest inside lower front cover panel. Carefully pull the harness completely through when panel is removed in Step 28.

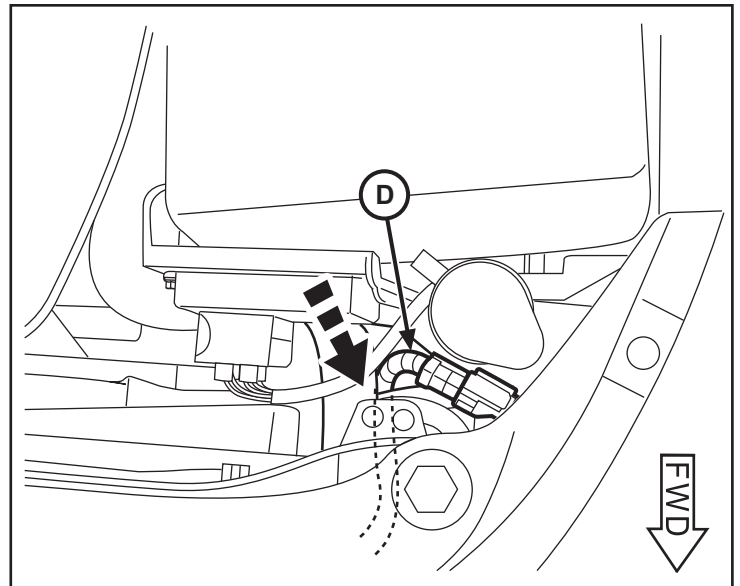

23. Use one (1) 10mm bolt and two (2) 10mm nuts to reattach the fuse box.

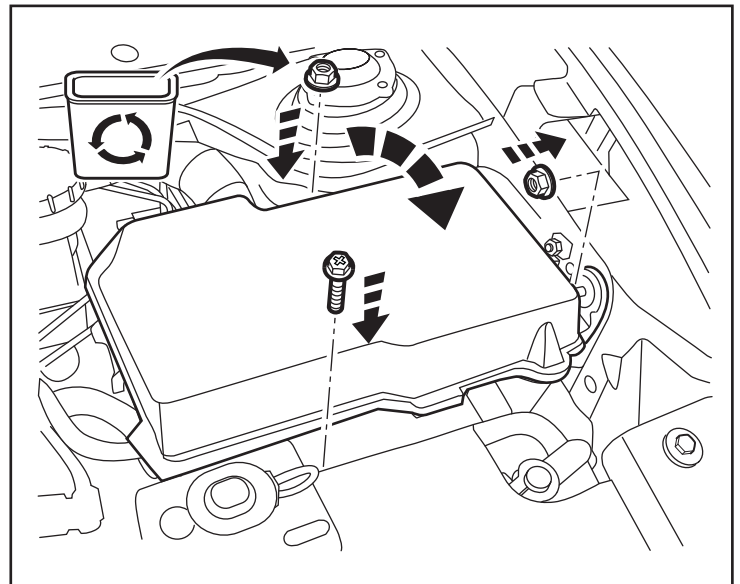

24. Raise the vehicle.

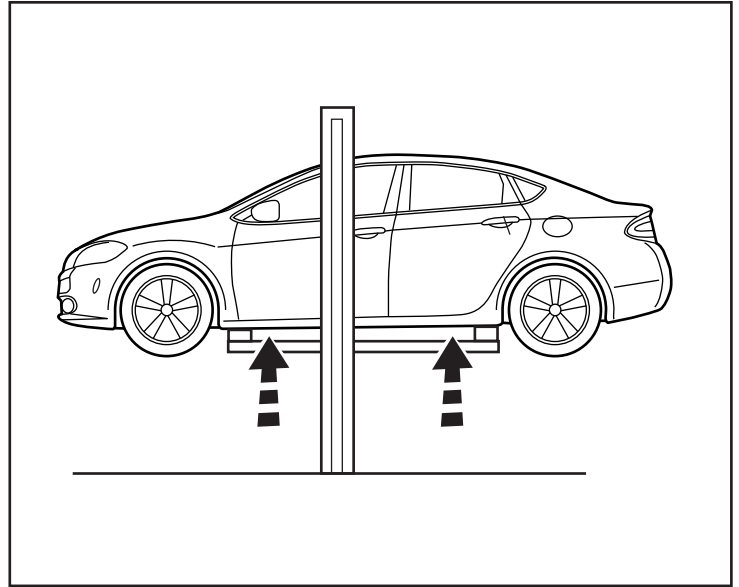

25. Use a trim stick to carefully pry out the stock trim bezels from the fascia on both sides.

Be careful not to scratch or damage the fascia.

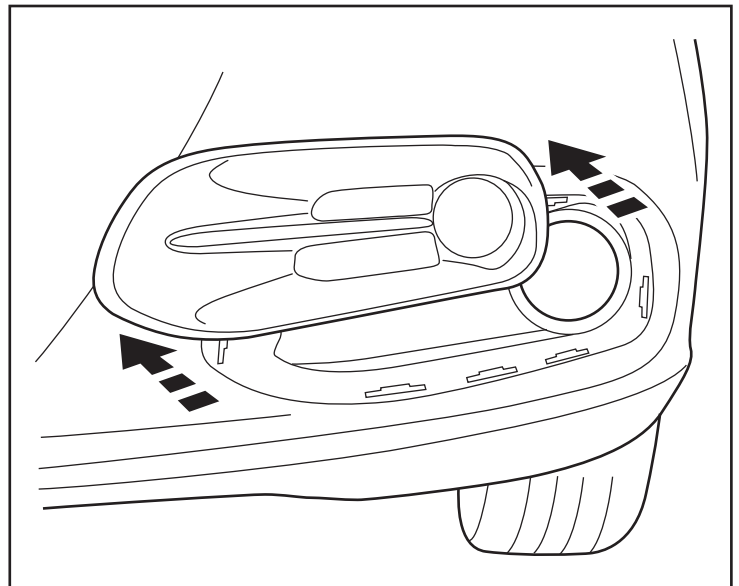

26. Carefully insert the new fog lamp bezels.
Be sure all clips are securely snapped into place.

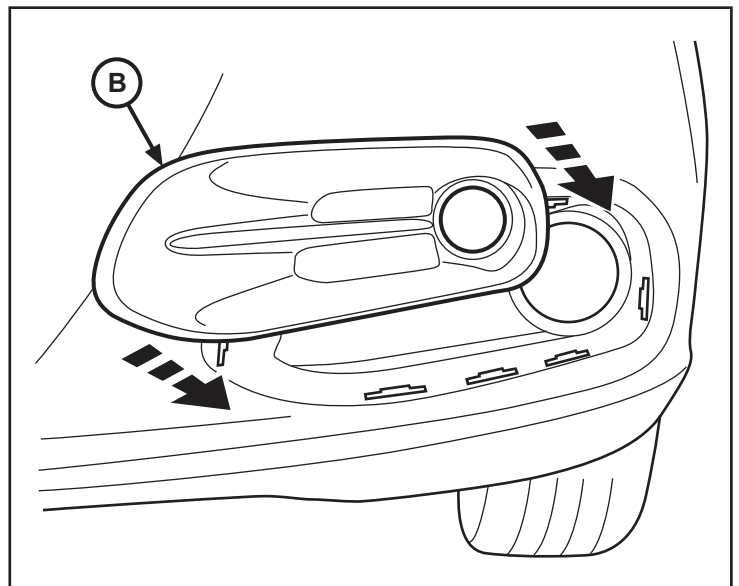

27. Remove twelve (12) 10mm bolts from engine cover panel. Remove the panel.

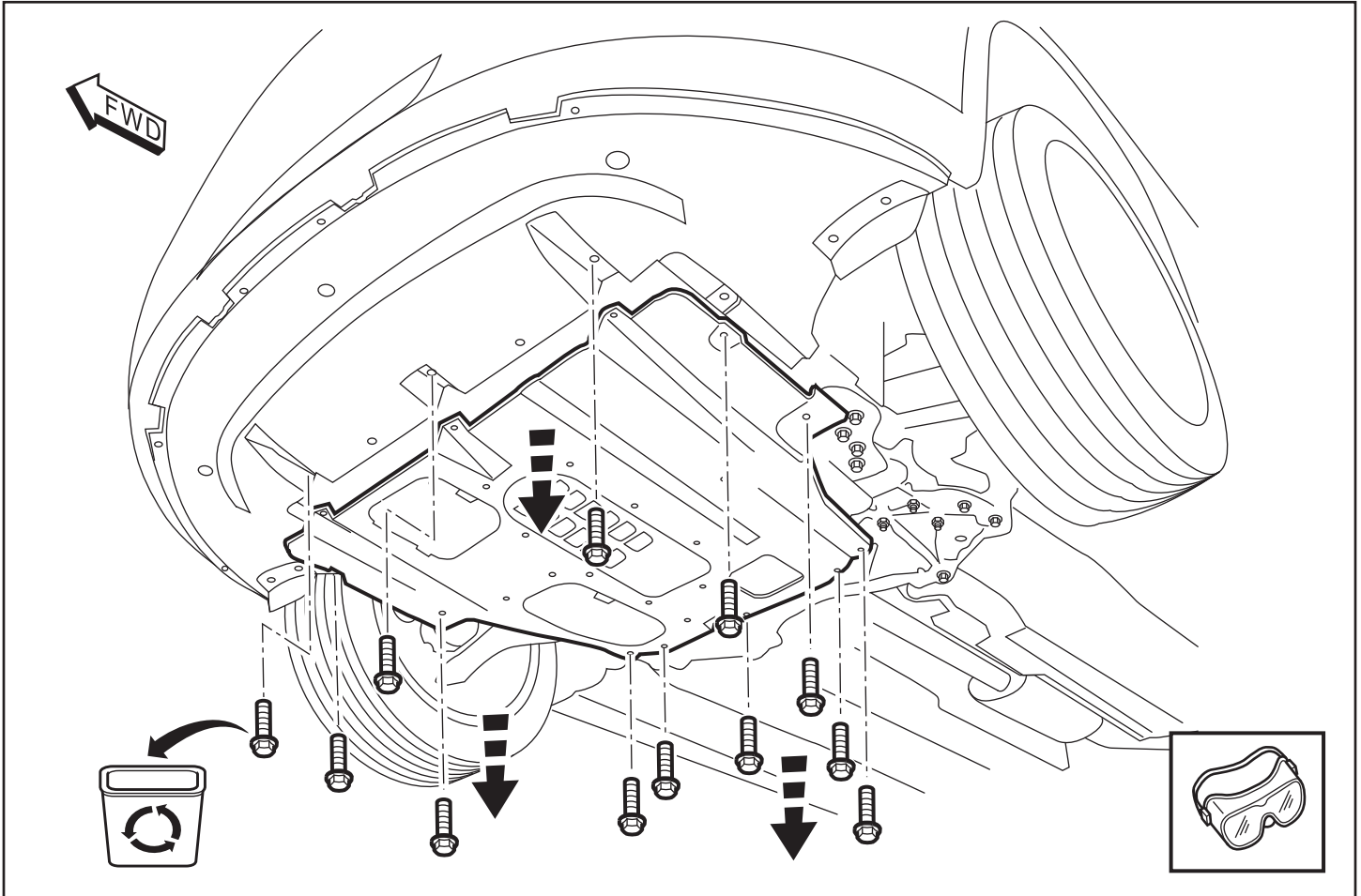

28. Remove six (6) 8mm bolts and two (2) press clips from front cover panel. Remove the panel.

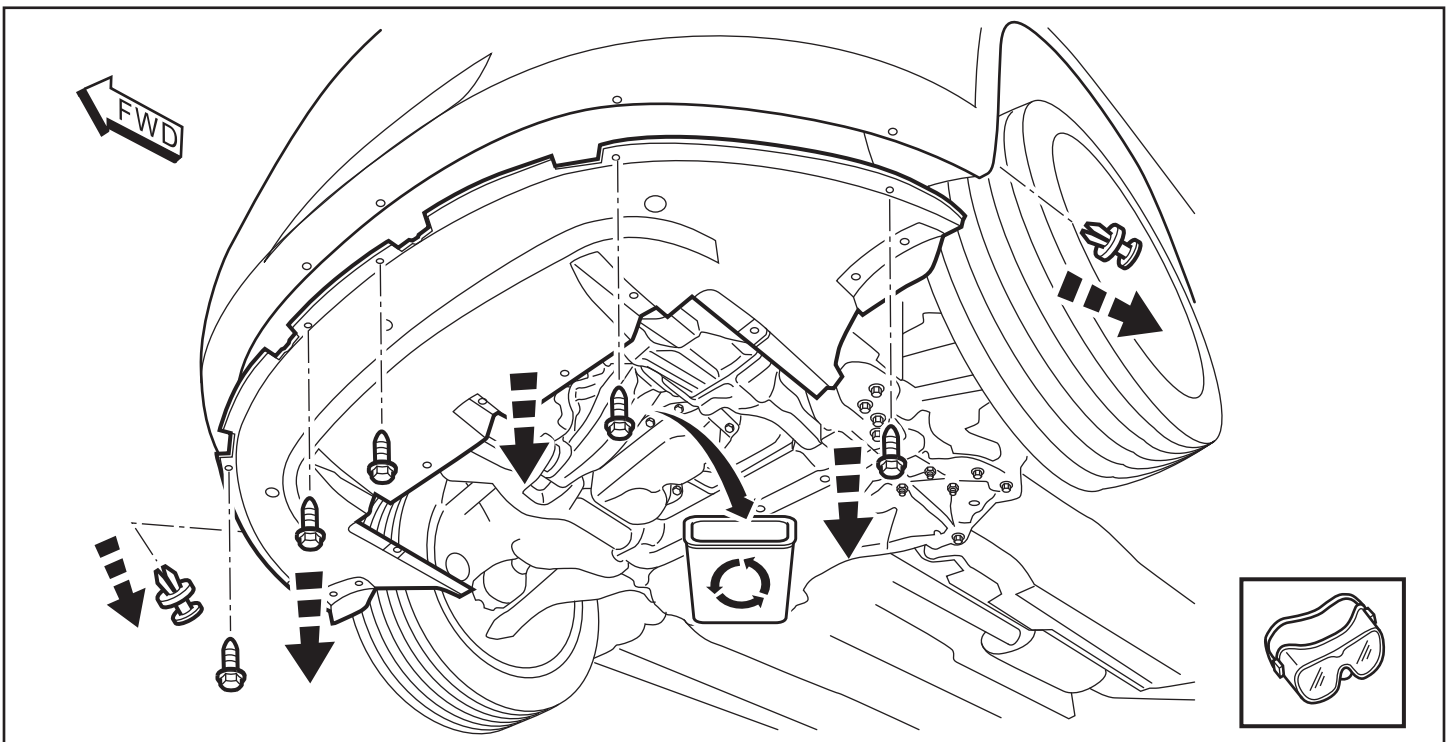

29. Position the fog lamp assembly behind the fascia opening. Align the four slots in the mounting ring with the latching tabs. Apply firm and even pressure until the fog lamp assembly snaps into place.

Repeat for driver side.

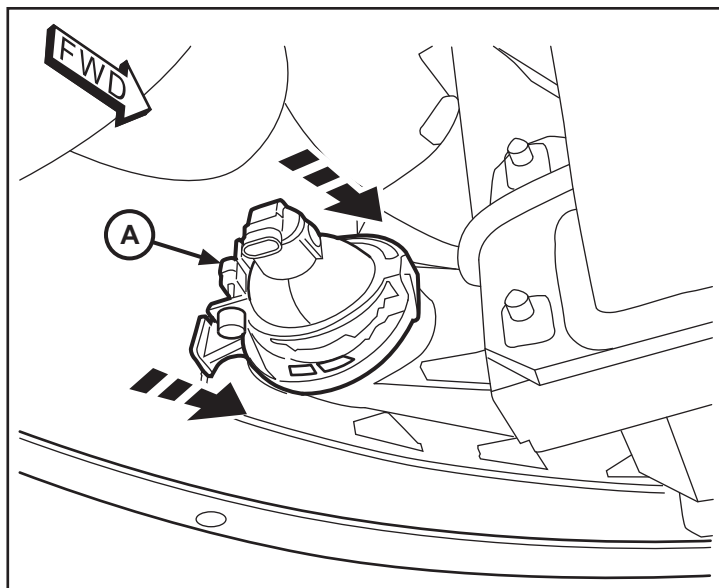

30. Plug the end of the fog lamp harness in the fog lamp connector.

Repeat for driver side.

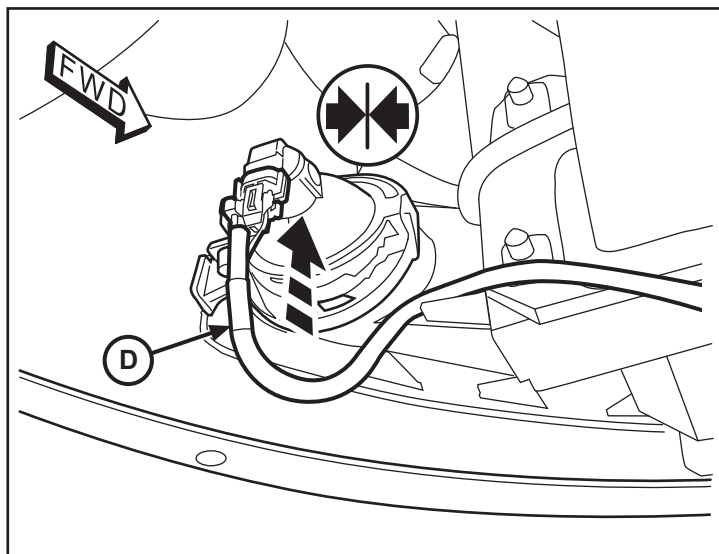

31. Locate the small stud on the side of the metal flange directly above the driver side frame rail. Remove one (1) 10mm nut and use it to attach the ground wire eyelet to the stud.

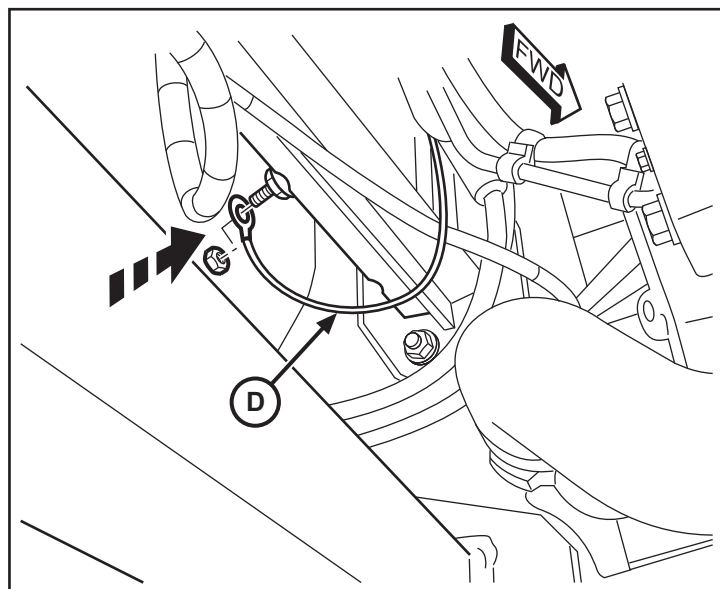

32. Secure the fog lamp harness with cable ties along the existing harness under the front fascia.

NOTE: Cable ties should be spaced no farther than 100mm apart on the outside of the vehicle.

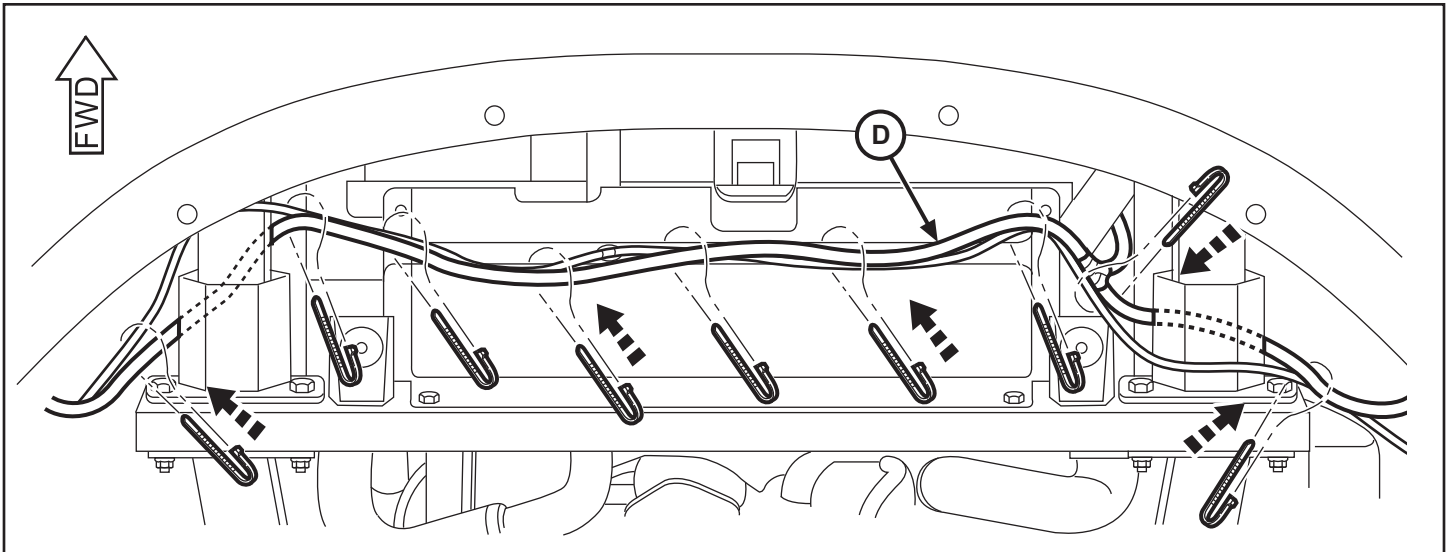

33. Drill a 3/16 inch hole in the plastic tab just inside the fog lamp mounting and secure harness with a cable tie as shown.

Repeat for driver side.

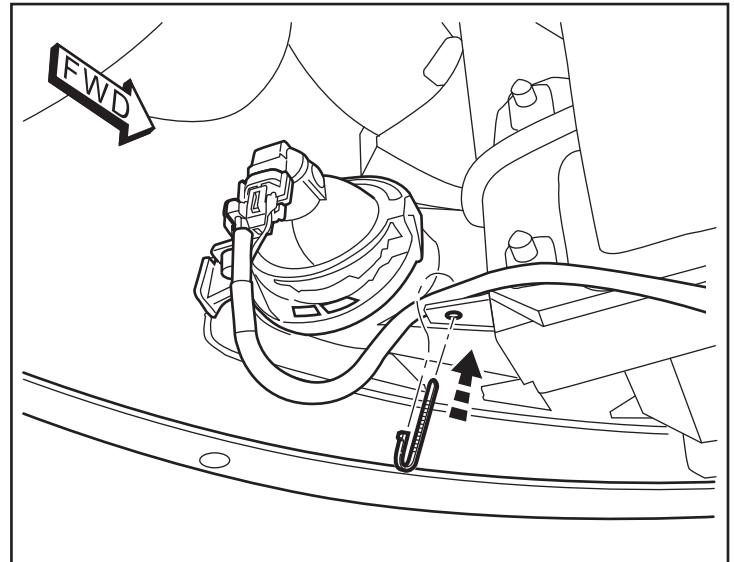

34. Remove the original headlamp switch by following these steps:

- 1) Turn the knob to the OFF position.
- 2) Push in on the knob to engage the retractor mechanism.
- 3) With the knob pushed in, rotate the knob clockwise (right) to retract the two retaining tabs.

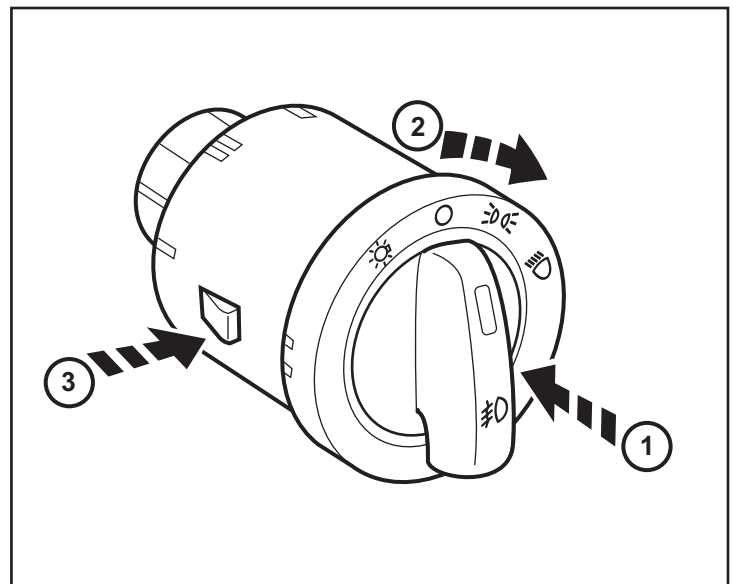

35. Hold the knob in the turned position and remove the headlamp switch from the dash panel.

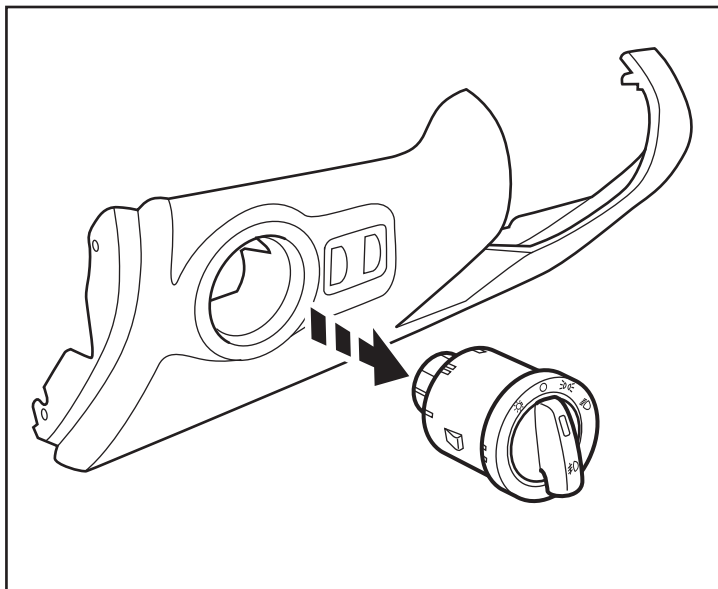

36. Align the new headlamp switch with the dash panel opening and press the switch assembly into place. You should hear the retaining tabs click into place.

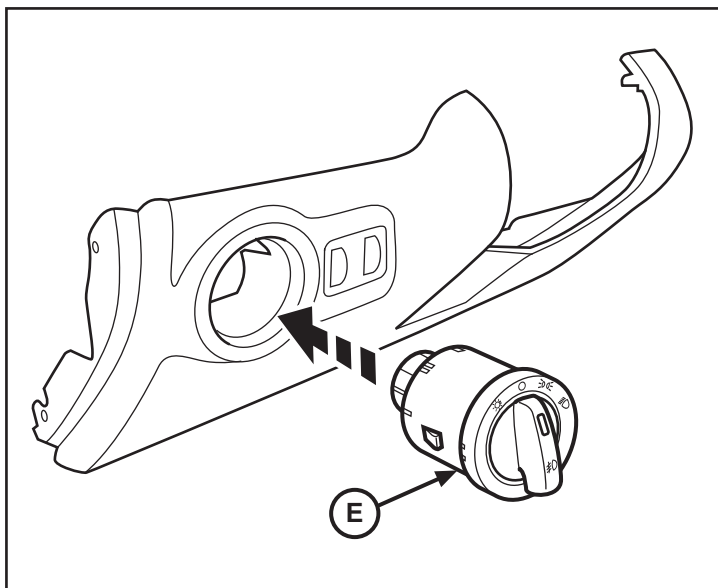

37. Check all wiring and trim all cable ties.
38. **Reverse steps 27 and 28 to reinstall underbody cover panels.**
39. Lower the vehicle.
40. **Reverse steps 3 through 8 to reinstall all interior panels and connectors.**
41. Reconnect the battery.
42. Follow the BCM Configuration and Fog Lamp Alignment Instructions on the next page.

BCM Fog Light Configuration

Vehicle VIN must be updated with the sales code of the added accessory in order to enable system functionality. Using the DealerCONNECT website and the scan tool, complete the procedure below:

- 1) Log on to <https://dealerconnect.chrysler.com>
- 2) In the service tab, inside the Warranty Administration box, locate "Vehicle Option Updates." Enter the vehicle VIN and add the sales code LNJ (Fog light) as a "Dealer Installed Option."
- 3) Confirm that the new sales code has been successfully added to the VIN.

With the scan tool connected to both the internet (via Ethernet port or wireless connection) and the vehicle, follow the steps below:

- 4) Use scan tool to run Restore BCM Proxi Configuration which can be found in the Vehicle Preparations tab of the main topology screen. Following the prompts will upload the new vehicle PROXI configuration to the BCM.
- 5) Once that is done, run Proxi Configuration Alignment found in the Vehicle Preparations tab to update the rest of the ECUs on the vehicle with the PROXI configuration that is now stored in the BCM.
- 6) Follow the step by step instructions on the scan tool to complete the Fog light vehicleconfiguration.

Fog Light Alignment

The fog lamp adjustment screw is accessed through clearance holes near the right and left outboard ends of the belly pan below the front fascia. A properly aimed front fog lamp will project a pattern on the alignment screen 100mm (4 inches) below the fog lamp centerline and straight ahead of the lamp.

- 1) Turn the fog lamps ON.
- 2) Rotate the fog lamp vertical adjustment screw on each lamp to adjust the beam height as required.